

**IN THE MATTER OF  
AN APPLICATION FOR VILLAGE GREEN STATUS  
OF LAND AT MILLFIELD ROAD, MARKET DEEPING**

---

**WITNESS STATEMENT OF NICHOLAS IAN WILLEY**

---

1. My name is Nicholas Ian Willey, I am currently employed as the Gypsy and Traveller Liaison Officer by Lincolnshire County Council ("the Council") and I am based at the County Offices, Newlands, Lincoln, LN1 1YL. I am a qualified housing professional who up until recently was a member of the Chartered Institute of Housing and I also hold a BTEC Advanced Award in the Management of Gypsy/Traveller Sites
2. I have held this position since June 2008 and my day to day duties include the monitoring of the management of the Council owned Gypsy/Traveller sites, the lead council official when dealing with unauthorised encampments on land that is owned and/or the responsibility of the Council, liaison with other public authorities on Gypsy/Traveller issues and other corporate property duties.
3. On Monday 19<sup>th</sup> June 2017, I opened an email sent to me on Saturday 17<sup>th</sup> June from a local district councillor informing me that Travellers had returned to the land known as the Old Showfield Site, Millfield Road, Market Deeping. This parcel of land is owned by the Council but is currently let to a local farmer. I was informed that they were part of the same group that had previously stopped there between 30<sup>th</sup> May and 2<sup>nd</sup> June 2017.
4. During their initial visit it was reported that there were six caravans and a similar number of vehicles. The tenant of the land had spoken to the group at that time and agreed that he would not initiate action to remove them providing they left by 2<sup>nd</sup> June 2017 which accordingly they did. Once the site

was clear, I was informed by the Council's land agent that the tenant had taken steps to secure the land.

5. Given that the Travellers had returned in such a short period of time and caused damage to metal access gates to gain entry on to the land, LCC made the decision to act directly. In accordance with the Council's procedure for dealing with unauthorised encampments I prepared the necessary paperwork and visited the group on Tuesday 20<sup>th</sup> June 2017. I arrived at the site around 10.00am and drove down Millfields Road. The Old Showfield site was on my left hand side. I passed three entrance/exit points to the land, the first two of which were open to access whilst the third point appeared secure. I also spotted some caravans stationed on the land. After I had driven pass the site, I turned my car around and parked up just off Millfield Road. It had been reported to me that the Travellers were aggressive and threatening.
6. I noticed that there were three caravans stationed on the land and two vehicles. The caravans and vehicles were in the central part of the Old Showfield site opposite the middle entrance/exit to the site. As I walked through this access on to the land I saw that the metal entrance gates had been damaged so I took a picture of this on my phone as evidence .(Enclosure 1) On the right hand I noticed a hedge and dyke running east to west splitting the field. However around half way into the field the dyke appeared to be culverted allowing vehicular access between the two parcels of land after which the hedge and dyke continued up to the western boulder edge of the field. The first caravan was stationed just before the culvert.
7. As I approached the first caravan I could see two females sat outside in conversation. I introduced myself and shortly afterwards a third female joined us from the furthest caravan parked away from the field entrance along the western boundary. I explained that they were camped on land belonging to the Council and that the Council had received several complaints from concerned local residents about noise, litter and other anti-social behaviour. I pointed out that the entrance gates appear to have been damaged to gain entry into the field which the woman denied any knowledge of how this had



happened. I explained that given all these issues the Council were considering taking action immediately to re-possess the land. As part of this process the group were asked if they had any welfare needs they wished to highlight which they wanted the Council to consider as part of its decision making process (Enclosure 2). They stated they had no health, education or accommodation needs that they wanted the Council to consider as it was their intention to move off the land within days and out of the county. The group were friendly throughout our conversation. I was with the group for about an hour during which time no other person/s entered the land.

8. When I got back to my vehicle I drove back towards the B1525. As I was driving I stopped at the first entrance/exit access point as it was open to access. I parked my vehicle and got out to view it. I noticed that the gates normally preventing access were also damaged so again I took a picture of this for evidence. Although there were no caravans or vehicles stationed on this part of the field, I could see that a vehicle had recently used the access point as there was long grass in the field that had been flattened. It appeared that the vehicle/s had driven towards the central part of the field and over the culverted part of the dyke. Having gathered the information I required, I got back in my car and left the area.
9. The Travellers left the site on 27<sup>th</sup> June 2017, the day before a re-possession case and application for an injunction order was due to be heard in the County Court. (Enclosure 3)

I believe that the facts and information stated in this statement are true and are made from my own knowledge.

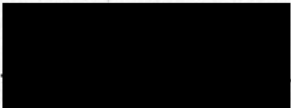
Signed .....  .....

Dated ..... 9/1/2018 .....



Land Registry  
Official copy of  
title plan

Title number LL290851  
Ordnance Survey map reference TF1210SE  
Scale 1:2500  
Administrative area Lincolnshire: South Kesteven



© Crown Copyright. Produced by Land Registry. Reproduction in whole or in part is prohibited without the prior written permission of Ordnance Survey. Licence Number 100025316.

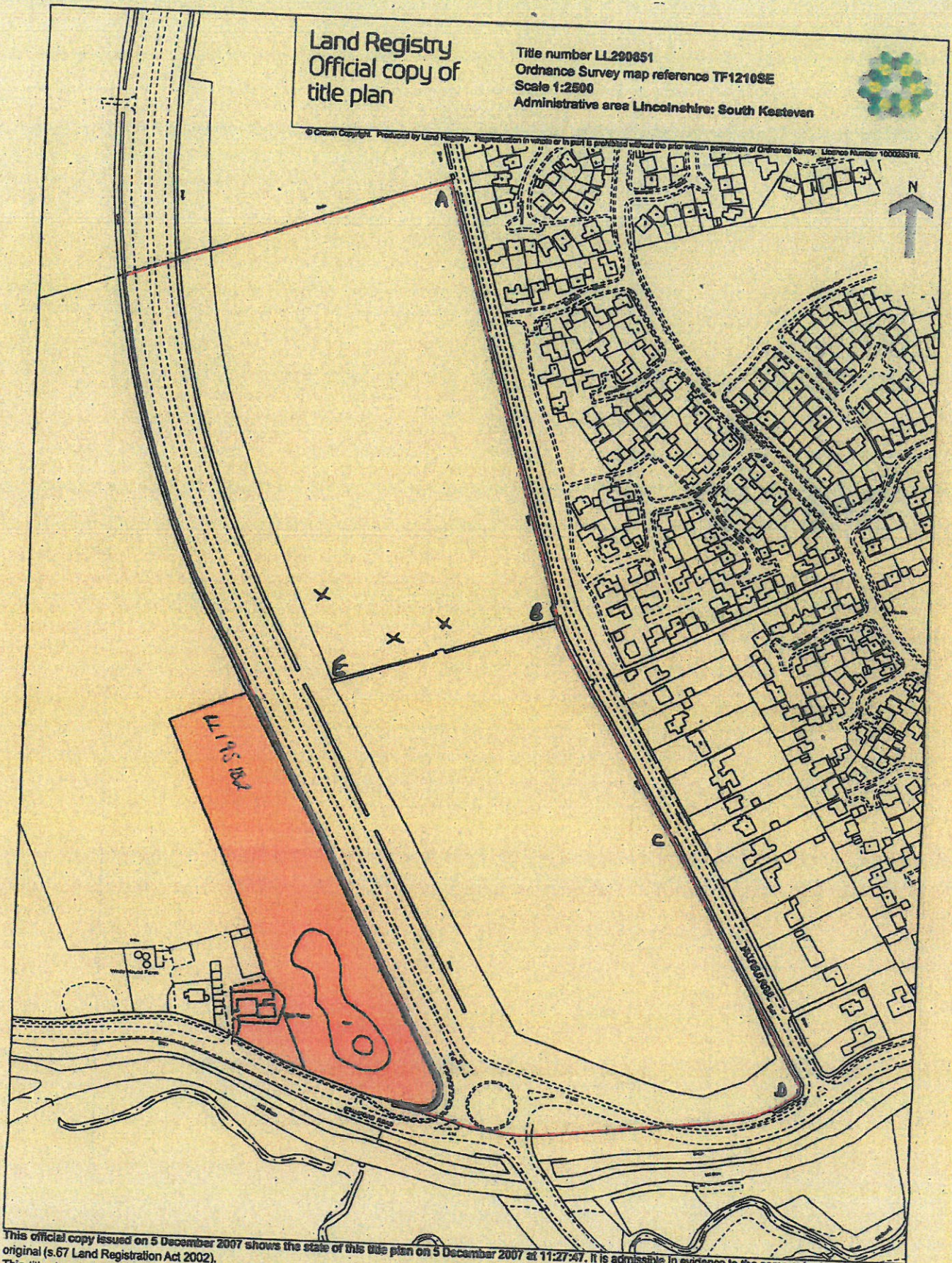

This official copy issued on 5 December 2007 shows the state of this title plan on 5 December 2007 at 11:27:47. It is admissible in evidence to the same extent as the original (s.67 Land Registration Act 2002).  
This title plan shows the general position, not the exact line, of the boundaries. It may be subject to distortions in scale. Measurements scaled from this plan may not match measurements between the same points on the ground. See Land Registry Public Guide 19 - Title Plans and Boundaries.  
This title is dealt with by Land Registry, Kingston upon Hull Office.

Photo 1+2 taken from entrance (marked B) looking towards mark E on the map.  
Photo 3 Gate at entrance (marked B) on above map in open position  
Photo 4 Gates at entrance (marked B) on above map in closed position